

PERFORMANCE CABLETRAY™

2024

PRODUCT CATALOG

WBT
LLC



PERFORMANCE CABLETRAY™

What exactly is performance cabletray? Look no further.

WBT was created to offer the best in cable management products to the market today. WBT's industry leaders reviewed every tray construction, hardware bracket and splice solution, asking, how can we make it better, easier and faster to install?

We often make the point that WBT solves installation problems that many didn't even know they had. We are a company of 'firsts'. We manufacture the best, most robustly constructed products in today's market. We ship faster and we service our customers to a level that few companies do today, with unparalleled leadtimes and customer service.

Our premise is simple. A higher quality 'PERFORMANCE' cabletray, 100% manufactured in the U.S., utilizing 100% domestic recycled steel, with minimized environmental impact finishes. WBT offers better cabling support, opportunities for LEED submittal documentation, and engineering support. Our Shaped Wire (*Patented*) constructions are documented to decrease pressure/strain on high performance cabling up to 65%.

Today, a majority of the industry trends towards cheap tray constructions with thinner, weaker wires, and leadtimes measured in weeks, not days. Most don't even make their own products. Instead, it's farmed out to be contract manufactured by others. This is not the WBT business model.

WBT is a company designed and created with a sole purpose, to provide the BEST in mesh cabletray, while supporting you and your customers with the most innovative and creative products in the market, period.

Welcome to WBT, where we are shaping the future in cabletray. Browse through our catalog and see the results of almost 45 years of combined mesh experience, new ideas and fresh approaches to your needs.



SHAPED CROSSWIRE

All wire tray manufacturers utilize round wire in the construction of their trays. Today, unfortunately, the trend is towards smaller, cheaper, lighter gauge constructions. The problem is that high performance cabling installed in the tray today has evolved several generations.

A round crosswire supporting a round cable offers very little surface area support. When you add additional cables, the weight creates a pressure point/strain on the cables within the tray. What WBT has pioneered is a design utilizing shaped crosswires, which increases the support of your critical cabling.

WBT's shaped crosswires eliminate cable stress by increasing the support of the cabling, yet still offers the same functionality of wire tray to cut and configure, and utilizes the same splicing and mounting hardware.

WBT does offer the full round wire configuration, if preferred, or for industrial or electrical applications where you're not facing the same performance issues, or where inserts are being utilized.

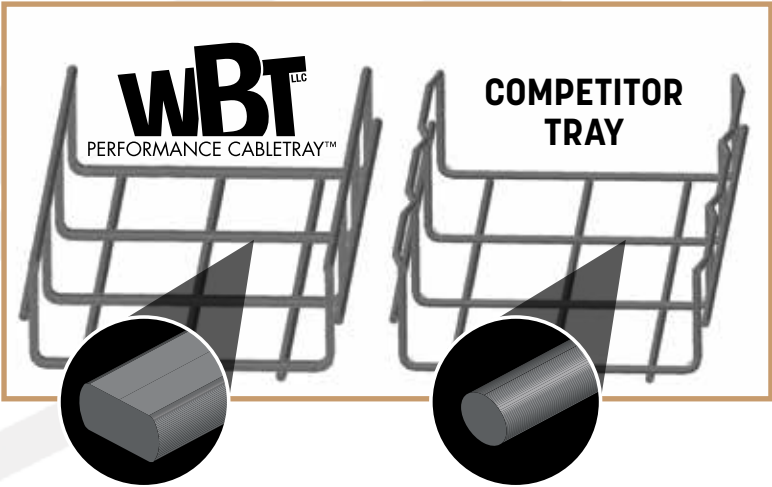

CABLE PRESSURE REDUCTION

CONTACT AREA SQUARE INCH	FLAT LOAD LBS.	WIRE PRESSURE PSI	BENDING STRAIN INCHES	CONTACT AREA SQUARE INCH	ROUND LOAD LBS.	WIRE PRESSURE PSI	BENDING STRAIN MICROINCHES	DECREASE IN STRAIN FLAT VS. ROUND
.03125	.1291	4.1	18	.00781	.1291	16.5	24	33.3%
.03125	.1876	6.0	27	.00781	.1876	24.0	44	63.0%
.03125	.2507	8.0	38	.00781	.2507	32.1	61	60.5%
.03125	.3168	10.1	51	.00781	.3168	40.6	74	45.1%
.03125	1.1023	35.3	113	.00781	1.1023	141.1	187	65.5%

* Please contact WBT for our independent study testing round versus WBT's shaped wire constructions.

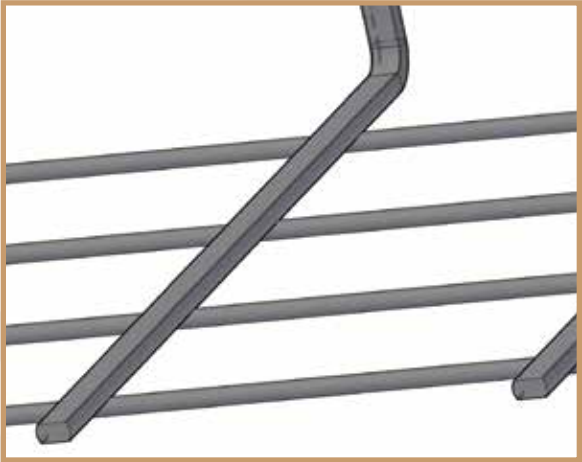
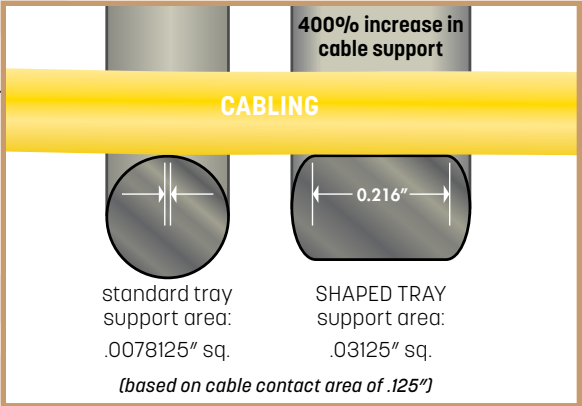

OUR SHAPED WIRE OFFERS:

- A Minimum 400% Increase in Cabling Support
- Up To 65% Reduction in Cabling Pressure/Strain (see table)*
- 100% Domestic Recycled Content
- 100% Domestic Manufactured Tray
- Cuts, Configures and Splices the Same
- No Premium over Competitors 'Old Round Crosswire'

SHAPED TRAY

01

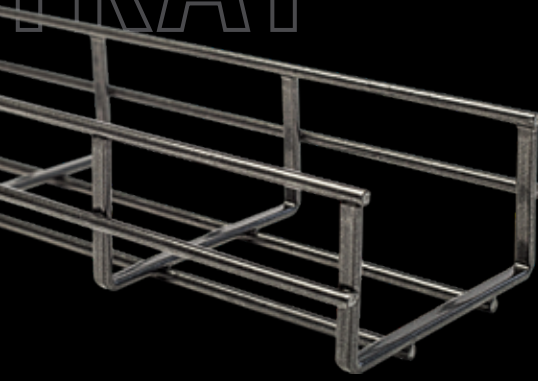

WBT Shaped Tray

Shaped tray means more support for your cabling. Independently verified and tested more support. Like 400% more support and decreased cable strain averaging 65%. Put your expensive cabling in a better home.

WBT PREFORM

02



WBT Preform

So, you're not into saving 70% to 90% on installation time, and providing a better looking more uniform and engineered pathway? Don't install tray the 'old fashioned' way. It's PreForm or old form.

WBT GREEN

WBT Green

WBT strives to utilize 100% domestic recycled steel content in all our tray offerings. We can even potentially help with LEED credits.



WBT FORM

06



WBTForm

WBT introduced the concept of flame retardant polymer liner in tray. WBTForm is used to disguise the contents of the pathway. Available in bottom or bottom/sides configuration. We stock in black, white and yellow and offer an infinite number of custom colors and finishes. Go cool with a carbon fiber insert or faux marble. Limitless design options.

PAINTED TRAY

07



Limitless Tray Finishes

More and more, tray is being used as a design element. WBT's Architectural Series is where art meets function. Whether you're color coding pathways or matching a brand's identity, you can release your inner designer. Plus, with the 'other guys' field time is wasted removing paint at each splice point in order to properly bond and ground trays. With WBT there's no field removal of paint.

WBT T

WBT T

We provide a T weld on each and every standard tray we provide. Most of the cheaper guys don't, some provide it on most. We provide it on all, baby. Looking good and installer safety is kinda our thing.



03

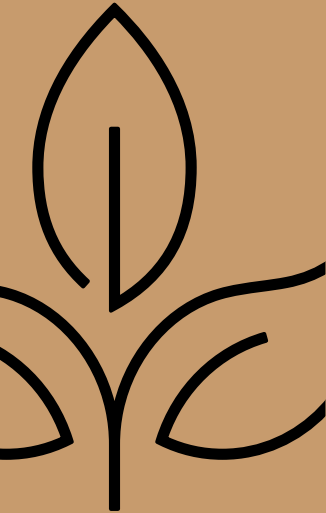

WBT

04

Double Splice



MADE IN THE USA

05

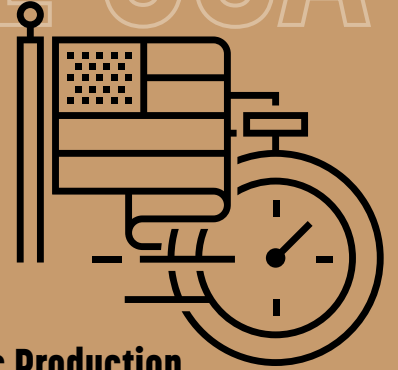

Domestic Production & Leadtimes

WBT has the largest manufacturing capacity of any domestic supplier. Our tray and support products are made in the good ol' USA, not shipped on containers from overseas. Leadtimes are measured in days, not weeks. Why should you have to wait and wait for delivery?

08

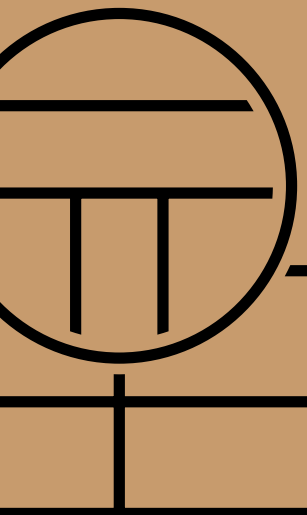

LOCATION

09



Production & Logistics

We manufacture and ship from two WBT facilities. One located in Southern Illinois and the other in Phoenix, AZ.

SERVICE

10



Service

When it comes to service, support and relationships ... we're as old school as they come. We supply innovative products with world class service.

INNOVATIONS FROM WBT

WBT is always looking for ways to help customers reduce costs and labor, while keeping our products at the leading edge of the marketplace. Our newest innovations include:

WBT PreForm, WBT Double Splice, WBT-3, Bridge and our new PowerShear cutting tool.

WBT PreForm PATENTED PAGE 8

Preformed radius/tee/intersections that saves installation time and labor. No field cutting or configuration, simply install as you would a straight section. Maintains UL Classification for fitting.

WBT Double Splice PAGE 12

Splices per tray have been reduced by half with Double Splice technology. Double Splice is more secure, provides faster installs, and still affords the UL Classified for properly bonding and grounding tray runs. And... only WBT offers white splice kits. That's right... white double splice kits!

WBT-3 PAGE 26

Another innovative approach, WBT has engineered a secure covering to completely hide and protect your cabling. WBT-3 provides needed protection, by hiding the tray and cabling in plain sight. With our integrated fastening system for WBT-3, cabling media is out of sight, while still allowing easy access to the pathway.

WBT Bridge PAGE 10

In the past, routing cables in different directions caused extra labor in order to ensure the cables were installed aesthetically, and without any damage.

The all new bridge system allows cables to be separated into their respective orientations without overlapping the cables or creating extra labor.

WBT PowerShear PAGE 11

PowerShear was developed in response to an absence of a solution for safely cutting and configuring wire mesh cabletray. PowerShear produces the clean-cut results by utilizing a compact, ergonomic cutting head that has been engineered to provide a faster, burr-free cut.

WBT T-WELD ON ALL TRAY CONFIGURATIONS

WBT provides a T-Weld edgewire on all of its tray configurations. This product design provides protection for both the installer and the cabling from any sharp points within the tray. *(excludes stainless constructions)*









WBT GREEN POINTS:

- Utilizing 100% domestic recycled steel content in the manufacturing of our trays
- MillCerts are available to document recycled content for possible LEED credits/certification
- No post production chemical cleaning and plating (*a huge environmental impact*)
- WBT utilizes kraft packaging (*no bleaching white*). Packaging and strapping are recyclable

WBT trays are available in a wide variety of finishes to meet the environmental or aesthetic requirements of your installations. Use the chart below to find the finish suffix that will meet your needs.

Finish codes: **WBT2x4 BL** = Tray Depth x Width x Finish

Notate finish code when ordering trays and fittings.

Suffix	Finish	Specifications	Use	UL/cUL
no suffix required	Pre-Galvanized Finish applied before fabrication	ASTM A641	Limited industrial & interior applications recommended	 on sizes below when spliced as recommended
ZP	Electro Zinc Plating	ASTM B633	Controlled interior applications	 on sizes below when spliced as recommended
PW	Pewter Powder Coated Finish applied after fabrication	N/A	Controlled interior applications	 on sizes below when spliced as recommended
BL	Black Powder Coated Finish applied after fabrication	N/A	Controlled interior applications	 on sizes below when spliced as recommended
WH	White Powder Coated Finish applied after fabrication	N/A	Controlled interior applications	 on sizes below when spliced as recommended
CUSTOM See WBT for suffix	Custom Powder Coated Finish applied after fabrication	N/A	Controlled interior applications	 on sizes below when spliced as recommended
304 & 316	304 Stainless Steel & 316 Stainless Steel	ASTM A580	Food preparation, wash-down areas, highly corrosive applications & marine environments	

UL CLASSIFIED & cUL CLASSIFIED ON PAINTED TRAY

WBT offers powder coated tray that is UL Classified and cUL Classified as an equipment ground conductor.

No field removal of the paint is required.



2" depth	4" depth	6" depth	8" depth
ROUND / SHAPED	ROUND / SHAPED	ROUND / SHAPED	ROUND / SHAPED
*WBT2x4 S	WBT4X6 / WBT4x6 S	WBT6X8 / WBT6x8 S	WBT8X8 / WBT8x8 S
WBT2x6 / WBT2x6 S	WBT4X8 / WBT4x8 S	WBT6X12 / WBT6x12 S	WBT8X12 / WBT8x12 S
WBT2x8 / WBT2x8 S	WBT4X12 / WBT4x12 S	WBT6X16 / WBT6x16 S	WBT8X16 / WBT8x16 S
WBT2x12 / WBT2x12 S	WBT4X16 / WBT4x16 S	WBT6X18 / WBT6x18 S	WBT8X18 / WBT8x18 S
WBT2X16 / WBT2x16 S	WBT4X18 / WBT4x18 S	WBT6X20 / WBT6x20 S	WBT8X20 / WBT8x20 S
WBT2X18 / WBT2x18 S	WBT4X20 / WBT4x20 S	WBT6X22 / WBT6x22 S	
WBT2X20 / WBT2x20 S	WBT4x24 / WBT4x24 S	WBT6X24 / WBT6x24 S	
WBT2X24 / WBT2x24 S			

***WBT is the only manufacturer that provides a UL Classified 2x4 tray construction, WBT2x4 S**

2" DEEP TRAY



SHAPED PART NUMBER	ROUND PART NUMBER	WIDTH	WT. per pc.	FILL*	LOAD lbs/ft**	SPLICE quantity
WBT2X4 S	WBT2X4	4"	8 lbs	108	45	2
WBT2X6 S	WBT2X6	6"	9 lbs	163	50	4
WBT2X8 S	WBT2X8	8"	10 lbs	218	52	4
WBT2X12 S	WBT2X12	12"	14 lbs	326	58	4
WBT2X16 S	WBT2X16	16"	18 lbs	439	70	4
WBT2X18 S	WBT2X18	18"	19 lbs	495	70	4
WBT2X20 S	WBT2X20	20"	22 lbs	550	73	5
WBT2X22 S	WBT2X22	22"	23 lbs	600	73	5
WBT2X24 S	WBT2X24	24"	24 lbs	660	75	5
WBT2X26 S	WBT2X26	26"	25 lbs	671	73	6
WBT2X28 S	WBT2X28	28"	29 lbs	723	73	6
WBT2X30 S	WBT2X30	30"	31 lbs	826	70	6
WBT2X32 S	WBT2X32	32"	32 lbs	881	70	6
WBT2X34 S	WBT2X34	34"	34 lbs	894	CONSULT WBT FOR FACTORY SPECIFICATIONS	
WBT2X36 S	WBT2X36	36"	35 lbs	947		
WBT2X38 S	WBT2X38	38"	36 lbs	1000		
WBT2X40 S	WBT2X40	40"	37 lbs	1052		

Finished tray length is 118 3/16"

*Fill is a theoretical calculation based on a .22" diameter cable and a 50% fill.

**Load (lbs.) are based on support spans of 6 feet.

4" DEEP TRAY



HOW MANY SPLICE KITS BOXES DO YOU NEED?

FORMULA FOR STANDARD SPLICE
 $\# \text{ of pieces of tray} \times A \div 50$

A = splice quantity in chart

DOUBLE SPLICE

Width 4 to 8 inch – 2 Double Splice

Width 12 to 18 inch – 3 Double Splice

Width 20 to 26 inch – 4 Double Splice

Width 28 inch and larger – 5 Double Splice

SHAPED PART NUMBER	ROUND PART NUMBER	WIDTH	WT. per pc.	FILL*	LOAD lbs/ft**	SPLICE quantity	DOUBLE SPLICE
WBT4X4 S	WBT4X4	4"	10 lbs	205	49	4	2
WBT4X6 S	WBT4X6	6"	11 lbs	310	49	5	2
WBT4X8 S	WBT4X8	8"	14 lbs	416	78	6	2
WBT4X12 S	WBT4X12	12"	18 lbs	621	78	6	3
WBT4X16 S	WBT4X16	16"	22 lbs	837	108	7	3
WBT4X18 S	WBT4X18	18"	23 lbs	942	116	7	4
WBT4X20 S	WBT4X20	20"	24 lbs	1047	116	7	4
WBT4X22 S	WBT4X22	22"	25 lbs	1152	116	8	4
WBT4X24 S	WBT4X24	24"	29 lbs	1257	116	8	4
WBT4X28 S	WBT4X28	28"	32 lbs	1460	CONSULT WBT FOR FACTORY SPECIFICATIONS		
WBT4X30 S	WBT4X30	30"	34 lbs	1578			
WBT4X32 S	WBT4X32	32"	35 lbs	1684			
WBT4X34 S	WBT4X34	34"	36 lbs	1789			
WBT4X36 S	WBT4X36	36"	37 lbs	1894			

Finished tray length is 118 3/16"

*Fill is a theoretical calculation based on a .22" diameter cable and a 50% fill.

**Load (lbs.) are based on support spans of 6 feet.

6" DEEP TRAY



SHAPED PART NUMBER	ROUND PART NUMBER	WIDTH	WT. per pc.	FILL*	LOAD lbs/ft**	SPLICE quantity	DOUBLE SPLICE
WBT6X8 S	WBT6X8	8"	18 lbs	623	116	6	2
WBT6X12 S	WBT6X12	12"	22 lbs	931	123	6	2
WBT6X16 S	WBT6X16	16"	24 lbs	1255	123	7	3
WBT6X18 S	WBT6X18	18"	25 lbs	1413	127	7	4
WBT6X20 S	WBT6X20	20"	29 lbs	1571	127	7	4
WBT6X22 S	WBT6X22	22"	31 lbs	1728	127	8	4
WBT6X24 S	WBT6X24	24"	32 lbs	1733	150	8	4
WBT6X26 S	WBT6X26	26"	34 lbs	1877	CONSULT WBT FOR FACTORY SPECIFICATIONS		
WBT6X28 S	WBT6X28	28"	35 lbs	2022			
WBT6X30 S	WBT6X30	30"	36 lbs	2166			
WBT6X32 S	WBT6X32	32"	37 lbs	2311			
WBT6X34 S	WBT6X34	34"	40 lbs	2455			
WBT6X36 S	WBT6X36	36"	43 lbs	2599			

Finished tray length is 118 3/16"

*Fill is a theoretical calculation based on a .22" diameter cable and a 50% fill.

**Load (lbs.) are based on support spans of 6 feet.

TRAY AVAILABLE IN 8, 10 & 12" DEPTH

KEY: WBT depthXwidth crosswire finish

(example: **WBT 4X18 S BL** = 4" deep X 18" wide Shaped Black)

DEPTH	WIDTH	CROSSWIRE	FINISH
2"-12"	2"-44"	S for shaped crosswire Blank for round crosswire	Blank for PreGalv ZP for Electro Zinc Plate PW/BL/WH for Standard Powder CUSTOM for Custom Powder (<i>See WBT for suffix</i>) 304/316 Stainless

CUSTOM TRAY

WBT can fabricate various custom configurations. Please contact the factory for details.

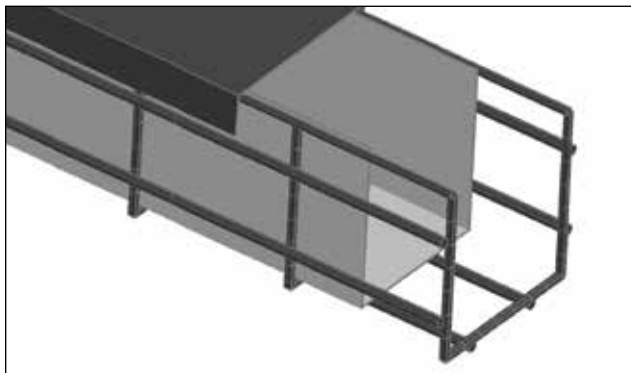

STANDARD FINISH:  AVAILABLE IN FINISHES: **BL**, **WH**, **PW**, **CUSTOM**, **ZP**

*WBT's fill rate is based on the NEC allowable fill of 50%. The NEC rule states that the cable cross section areas together may not exceed 50% of the tray area (width x depth = fill). Cables will almost completely fill the tray when reaching the 50% fill rate due to empty space between round cables and how the cables are installed.

Fittings for Tray Radius, Tee and Intersections

UL CLASSIFIED FITTINGS*

WBT PreForm is a time and cost effective solution to pathway tees, intersections, and radius bends, **no cutting... no configuring**. WBT PreForm simply attaches at the Intersection, Tee, or juncture when you want a radius bend. The sections are manufactured precisely to the trays being utilized, so it's a clean engineered solution. Vertical surfaces from tray to tray keep cables properly routed to avoid any excessive bends.

Installation of WBT PreForm can take installation configurations from hours to a few minutes. Labor and time savings can exceed 90%+ versus traditional cutting and splicing, all while avoiding sharp protrusions by less trained technicians.

WBT PreForm and Fittings allow you to retrofit to any installed tray pathway, and it doesn't lock you into a single sourced supplier with proprietary sections and solutions.

WBT PreForm sections ship in the flat for easy and quick installation, so no excessive transportation costs or likelihood of damage. Most can simply be shipped UPS to the job site.

- **NOW AVAILABLE:** Covers for PreForm. They work in conjunction with standard tray covers to provide full protection for pathway runs. Standard cover is aluminum, but also available in steel.
- **NEW:** PreForm now offers Reducer's both for tray, but also other junctures. Need a Tee configuration for 18" wide tray with a 12" tap... no issues.
- PreForm sides are available in white or black.
- **NEW:** WBT Transition. Allows for quick and engineered vertical transitions. Formed tray is bendable and field configurable. Splices to standard WBT tray.

**All PreForm fittings are UL Classified in galvanized finish*

KEY: WBT-juncture-depth X width finish
 (example: **WBT-R90-4X18 PG** = Radius 4" deep X 18" wide Pre-Galvanized finish)

JUNCTURE	DEPTH	WIDTH	MATERIAL
R45 - 45° Radius R90 - 90° Radius T - Tee I - Intersection	2"-6"	4"-30"	Steel Bottom with Flame Retardant Polymer Sides

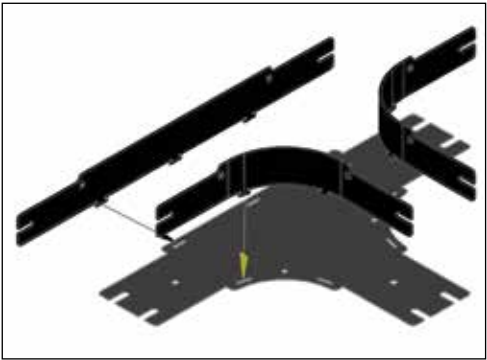

TIME SAVINGS CHART

CONFIGURATION	TRAY	TRADITIONAL CONFIGURATION	WBT PreForm	TIME SAVINGS (%)
RADIUS	2x8	7 minutes	1 minute	85%
RADIUS	4x12	20 minutes	2 minutes	90%
TEE (CORNER SPLICE)	4x12	8 minutes 45 seconds	2 minutes 30 seconds	70%
TEE (RADIUS)	4x18	10 minutes	2 minutes 30 seconds	74%
INTERSECTION	6x24	29 minutes	4 minutes 45 seconds	83%

RADIUS

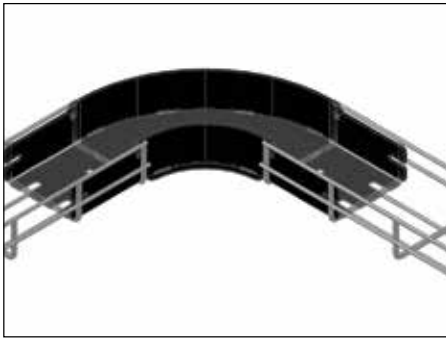

TEE

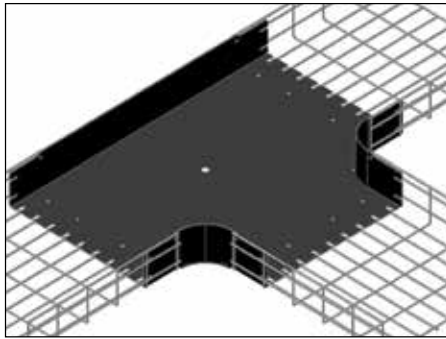

INTERSECTION

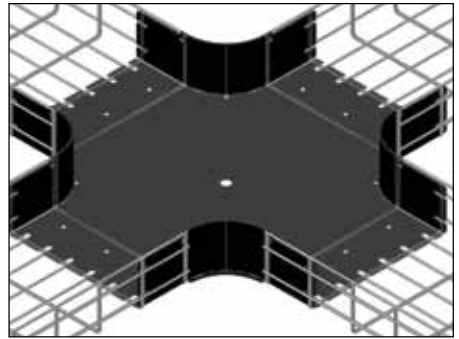

RADIUS COVER



TEE COVER

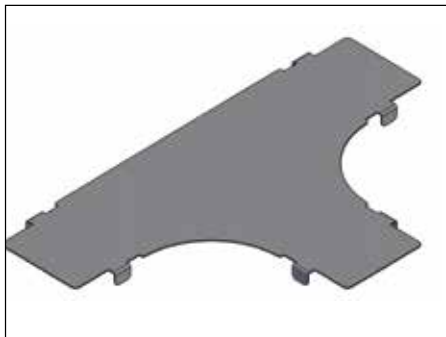

INTERSECTION COVER



TRAY REDUCER

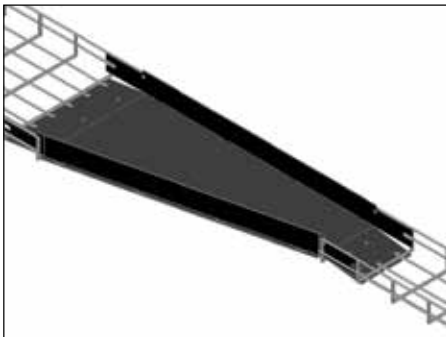

TEE REDUCER

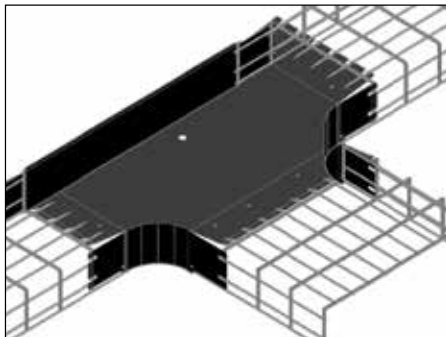

INTERSECTION REDUCER

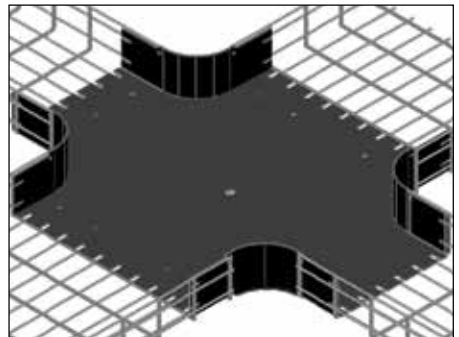

**NEW
WBT TRANSITION**

Allows for quick and engineered vertical transitions. Formed tray is bendable and field configurable. Splices to standard WBT tray.

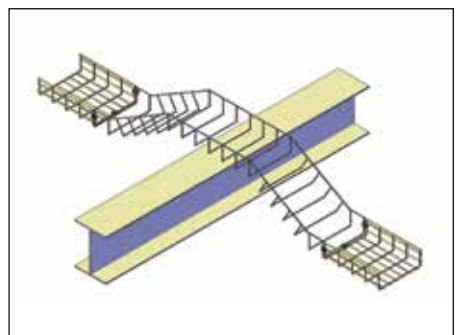
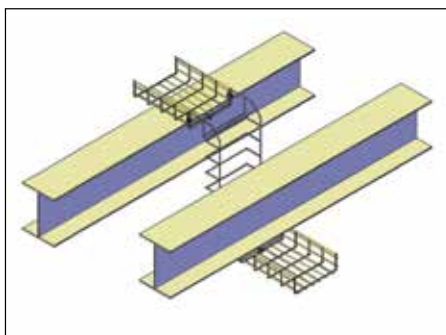

Separation made easy.

In the past, routing cables in different directions caused extra labor in order to ensure the cables were installed aesthetically, and without any damage.

The all new bridge system allows cables to be separated into their respective orientations without overlapping the cables or causing extra labor.

WBT Bridge is designed to simply slip over any installed PreForm fitting. There is no need for any additional installation labor.

TEE

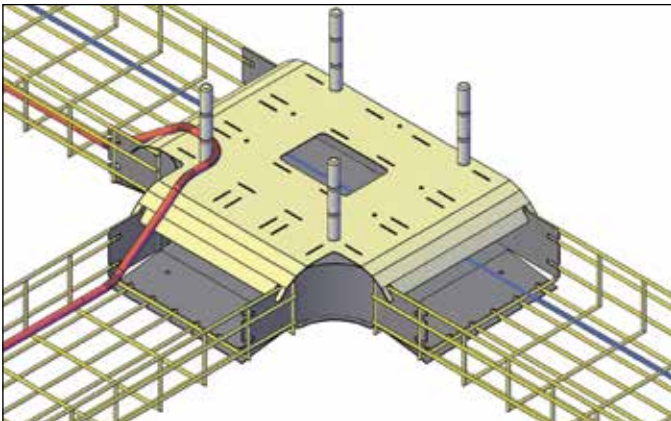
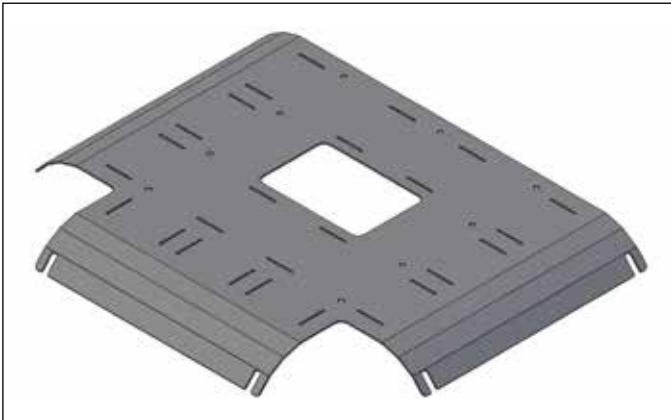

INTERSECTION

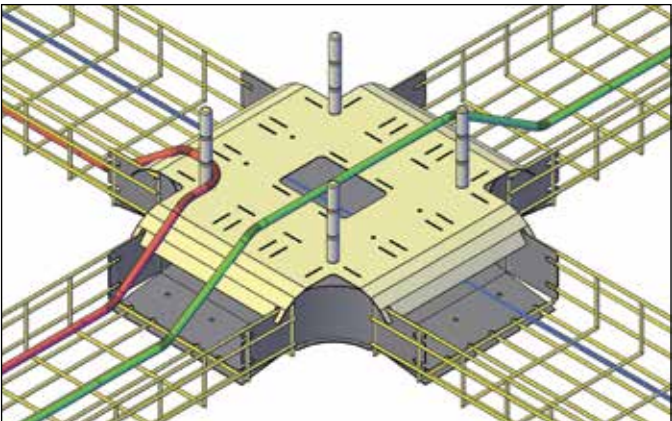
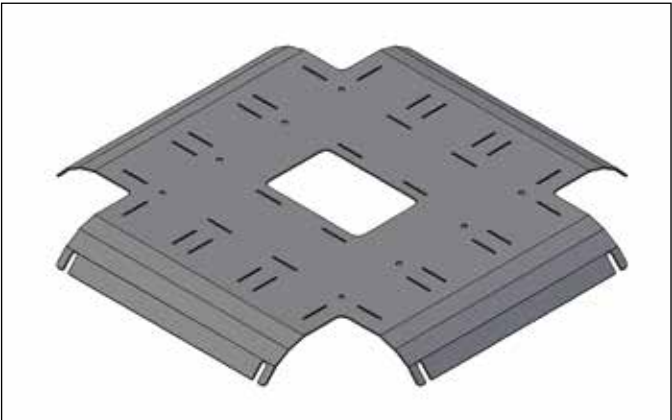

KEY: BRDG-junction X width finish
 (example: **BRDG-T-18 BL** = Bridge Tee configuration for 30" wide Black Powdercoat finish)

JUNCTURE	WIDTH	MATERIAL	FINISH
T - Tee I - Intersection	4"-36"	Steel	Blank for PreGalv ZP for Electro Zinc Plate PW/BL/WH for Standard Powder CUSTOM for Custom Powder (See <i>WBT</i> for suffix) 304/316 Stainless

A clean-cut solution.

WBT is proud to provide PowerShear to our partner installers. PowerShear was developed in response to an absence of a solution for safely cutting and configuring wire mesh cabletray.

Manual offset bolt cutters fail to provide a blunt, safe cut on any exposed cabletray, and current powered cutters leave the same result. By pinching the wire, a sharp point and edge is left in the tray which can be harmful to both the installer and cabling media.

PowerShear produces the clean-cut results by utilizing a compact, ergonomic cutting head that has been engineered to provide a faster, burr-free cut.

PowerShear was engineered with hydraulic damping, a small cutting head, easily replaceable shear blades, and a shear cut blade design. What this provides is a long-lasting product, the ability to cut cabletray easily without any grinding, and user-friendly blade replacement and cutting. This has led to the fastest and easiest cutting in cabletray.

- **Fast, user-friendly tool providing clean-cut results.**
- **No grinding or filing needed.**
- **Extended tool life.**
- **Replaceable shear blades, available from WBT.**
- **Quick battery charger available.**

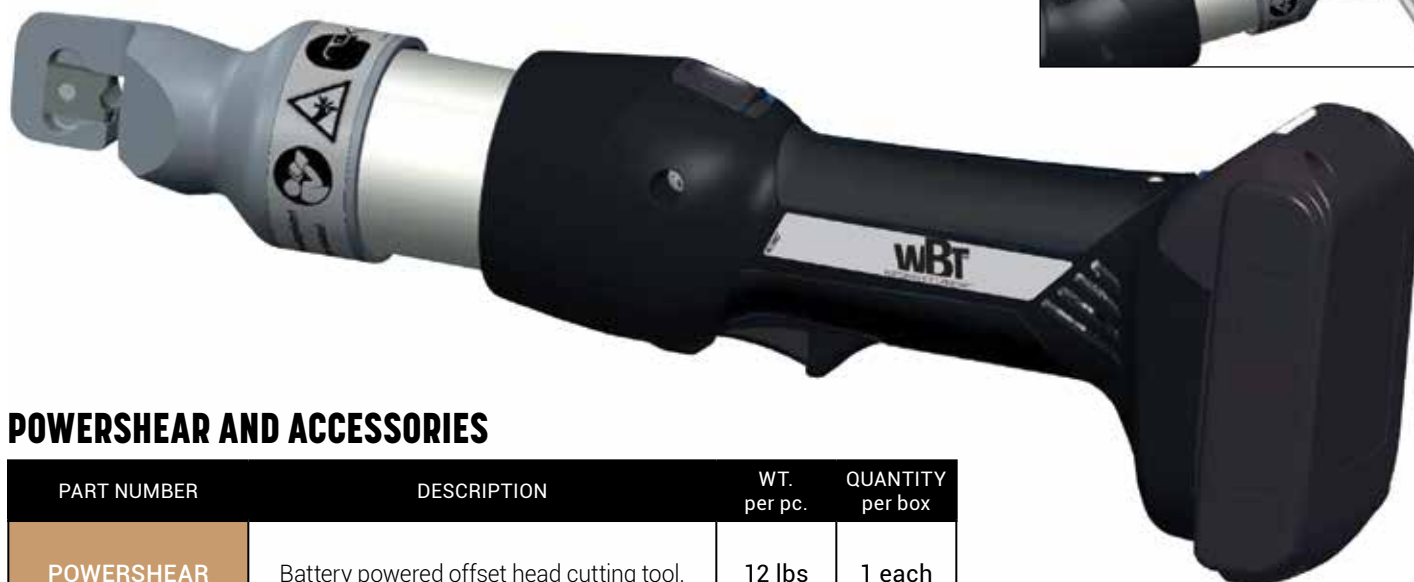

POWERSHEAR AND ACCESSORIES

PART NUMBER	DESCRIPTION	WT. per pc.	QUANTITY per box
POWERSHEAR	Battery powered offset head cutting tool.	12 lbs	1 each
PS BATT CRGR	18V 4Ah Li-ion battery and charger.	5 lbs	1 each
REPL BLADE	Set of replacement cutting blades.	1 lbs	1 each

SPLICE KIT



PART NUMBER	DESCRIPTION	WT. per box	QUANTITY per box
SPLICE KIT	3 piece staked bolt/washer and nut combination used to splice straight sections and fittings.	5 lbs	50 sets

STANDARD FINISH: ZINC PLATED | AVAILABLE IN FINISH: **BL**

DOUBLE SPLICE

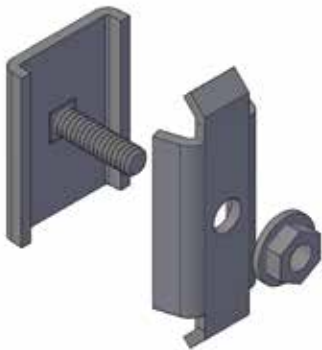

PART NUMBER	DESCRIPTION	WT. per box	QUANTITY per box
DOUBLE SPLICE	3 piece staked bolt/washer and nut combination used to splice straight sections and fittings. For use with 4"-8" depth trays.	8 lbs	50 sets

STANDARD FINISH: ZINC PLATED | AVAILABLE IN FINISH: **BL**

ANOTHER INNOVATION IN TRAY INSTALLATION

WBT introduces the Double Splice. Bolted tray connections are the most robust and offer the best tray grounding pathway of any splice option, and we've eliminated over 50% of the material cost and installation time with Double Splice.

Tray widths up to 12" only require 2 splices, and most larger sizes only require 3. This is a huge change from previous installs, sometimes requiring up to and over 8 splice points. Double Splice is more secure, provides faster installs, and still affords the UL Classification for properly bonding and grounding tray runs.

Double Splice is the fastest/most secure bolted splice option available, period! Don't risk tray failure by installing anything less.

WHITE DOUBLE SPLICE

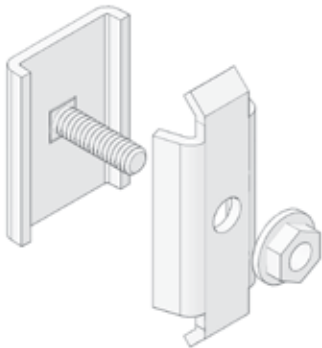

PART NUMBER	DESCRIPTION	WT. per box	QUANTITY per box
DOUBLE SPLICE	3 piece staked bolt/washer and nut combination used to splice straight sections and fittings. For use with 4"-8" depth trays.	8 lbs	50 sets

STANDARD FINISH: **WH** (UL CLASSIFIED)

THAT'S RIGHT... WHITE SPLICE KITS

Only WBT offers White Splice Hardware. Anyone else... nope, nada, zilch. UL Classified and approved.

RADIUS CORNER SPLICE



PART NUMBER	DESCRIPTION	WT. per box	QUANTITY per box
RADIUS CORNER SPLICE	Kit recommended for 2" depth tray used to splice corners. Each kit includes two corner splice bars and mounting hardware.	2 lbs	2 sets

STANDARD FINISH: ZINC PLATED | AVAILABLE IN FINISH: **BL**, **WH**, **PW**, **CUSTOM**

ALWAYS IMPROVING

WBT now offers both Corner Splice and a Radius Corner Splice options. Radius Corner Splice provides a soft 90 degree with a bottom filler to bridge and gap or space during the tray configuration. UL Classified.

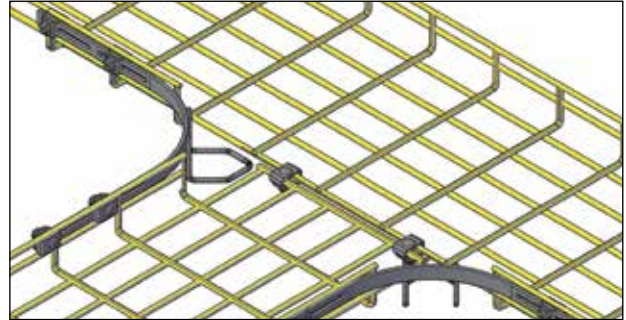

BAR SPLICE



PART NUMBER	DESCRIPTION	WT. per box	QUANTITY per box
BAR SPLICE	Slotted bar 11-15/16" long used to splice straight sections and fittings.	14 lbs	50 each

STANDARD FINISH: ZINC PLATED | AVAILABLE IN FINISHES: **BL**, **WH**, **PW**, **CUSTOM**

*SPLICE KIT SOLD SEPARATELY.

CORNER SPLICE



PART NUMBER	DESCRIPTION	WT. per box	QUANTITY per box
CORNER SPLICE	Kit used to splice fittings. Each kit includes two 90 degree splice bars and 8 sets of the splice kit.	1 lbs	1 kit

STANDARD FINISH: ZINC PLATED | AVAILABLE IN FINISHES: **BL**, **WH**, **PW**, **CUSTOM**

WASHER SUPPORT

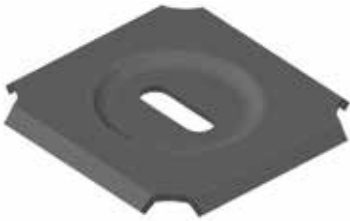

PART NUMBER	DESCRIPTION	WT. per box	QUANTITY per box
WASHER SUPPORT	2" square washer used as a hold down method or fitting splice.	6 lbs	50 each

STANDARD FINISH: ZINC PLATED | AVAILABLE IN FINISHES: **BL**, **WH**, **PW**, **CUSTOM**
 *1/4" BOLT AND NUT SOLD SEPARATELY.

1/4" BOLT & NUT



PART NUMBER	DESCRIPTION	WT. per box	QUANTITY per box
1/4 BOLT & NUT	1/4" Carriage Bolt & Finned Nut used with Washer Support.	1.6 lbs	50 each

STANDARD FINISH: ZINC PLATED | AVAILABLE IN FINISHES: **BL**

WASHER SUPT PLUS

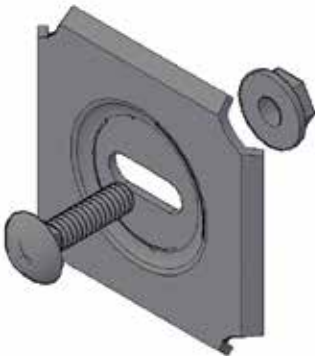

PART NUMBER	DESCRIPTION	WT. per box	QUANTITY per box
WASHER SUPT PLUS	1/4" Bolt & Nut & Washer Support. Used as a hold down method.	6.6 lbs	50 each

STANDARD FINISH: ZINC PLATED | AVAILABLE IN FINISHES: **BL**

SHELF SUPPORT



PART NUMBER	DESCRIPTION	WT. per pc.	QUANTITY per box
SHELF SUPT 4	Shelf/Wall support for 4" wide tray.	0.4 lbs	1 each
SHELF SUPT 6	Shelf/Wall support for 6" wide tray.	0.5 lbs	1 each
SHELF SUPT 8	Shelf/Wall support for 8" wide tray.	0.6 lbs	1 each
SHELF SUPT 12	Shelf/Wall support for 12" wide tray.	1.2 lbs	1 each
SHELF SUPT 16	Shelf/Wall support for 16" wide tray.	1.7 lbs	1 each
SHELF SUPT 18	Shelf/Wall support for 18" wide tray.	1.9 lbs	1 each
SHELF SUPT 20	Shelf/Wall support for 20" wide tray.	2.6 lbs	1 each
SHELF SUPT 24	Shelf/Wall support for 24" wide tray.	3.2 lbs	1 each

STANDARD FINISH: | AVAILABLE IN FINISHES: **BL**, **WH**, **PW**, **CUSTOM**

L BRACKET



PART NUMBER	DESCRIPTION	WT. per pc.	QUANTITY per box
L BRACKET 4	Wall L bracket for 4" wide tray.	0.7 lbs	1 each
L BRACKET 6	Wall L bracket for 6" wide tray.	0.8 lbs	1 each
L BRACKET 8	Wall L bracket for 8" wide tray.	0.9 lbs	1 each
L BRACKET 12	Wall L bracket for 12" wide tray.	1.4 lbs	1 each
L BRACKET 16	Wall L bracket for 16" wide tray.	1.5 lbs	1 each
L BRACKET 18	Wall L bracket for 18" wide tray.	1.7 lbs	1 each
L BRACKET 20	Wall L bracket for 20" wide tray.	2.1 lbs	1 each
L BRACKET 24	Wall L bracket for 24" wide tray.	2.3 lbs	1 each

STANDARD FINISH: | AVAILABLE IN FINISHES: **BL**, **WH**, **PW**, **CUSTOM**

C BRACKET



PART NUMBER	DESCRIPTION	WT. per pc.	QUANTITY per box
C BRACKET 4	Wall/Ceiling C bracket for 4" wide tray.	1.2 lbs	1 each
C BRACKET 8	Wall/Ceiling C bracket for 8" wide tray.	1.5 lbs	1 each
C BRACKET 12	Wall/Ceiling C bracket for 12" wide tray.	2 lbs	1 each
C BRACKET 18	Wall/Ceiling C bracket for 18" wide tray.	2.7 lbs	1 each

STANDARD FINISH: | AVAILABLE IN FINISHES: **BL**, **WH**, **PW**, **CUSTOM**

TRAPEZE SUPPORTS



PART NUMBER	DESCRIPTION	WT. per pc.	QUANTITY per box
TRAP SUPT	Trapeze style side support attaches to the side of the tray; suggested for tray sizes 16" wide & smaller.	9 lbs	50pcs/box

STANDARD FINISH:  AVAILABLE IN FINISHES: **BL**, **WH**, **PW**, **CUSTOM**

*ACCEPTS UP TO 3/8" THREADED ROD & SMALLER.

TRAPEZE SUPPORTS

- No polymer grommets required to hold threaded rod in place
- Able to support two individual sections of tray
- Works with splice hardware at tray junctions

STRUT CLIP



PART NUMBER	DESCRIPTION	WT. per pc.	QUANTITY per box
STRUT CLIP	Clip is a spring steel attachment/fastener, when using strut or channel to support cabletray.	1 lbs	50pcs/box

STANDARD FINISH: 

*ACCEPTS UP TO 3/8" THREADED ROD & SMALLER.

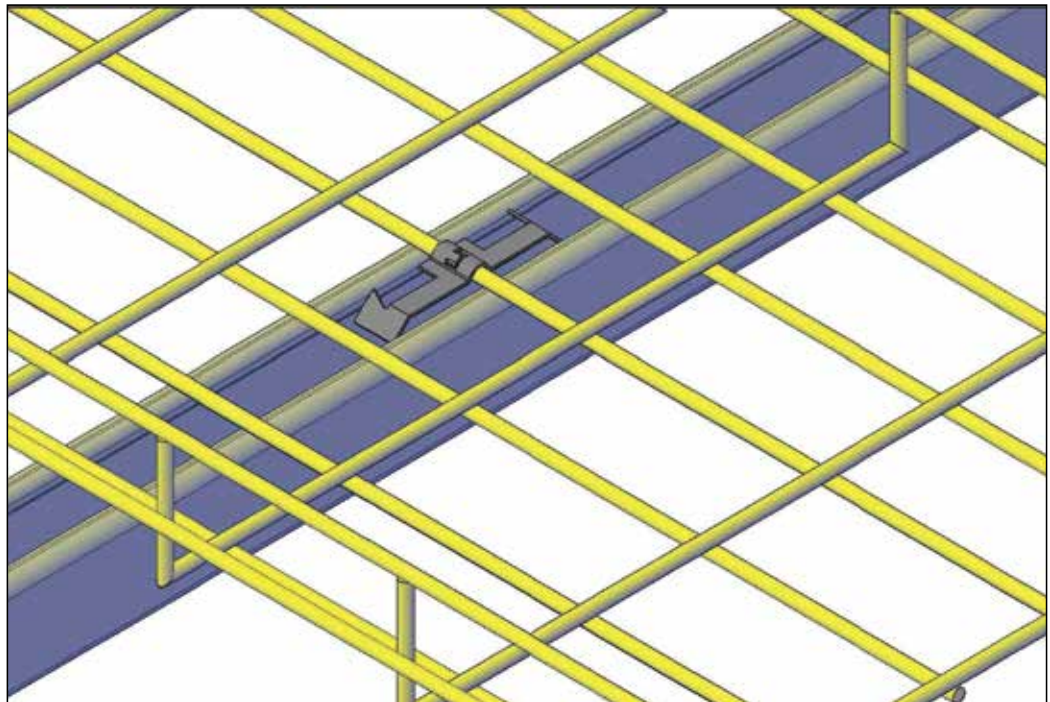

=PRE-GALVANIZED FINISH

CENTER SUPPORTS



PART NUMBER	DESCRIPTION	WT. per pc.	QUANTITY per box
CENTER SUPT 4	Center Support for 4" wide tray.	1.6 lbs	1 each
CENTER SUPT 6	Center Support for 6" wide tray.	1.8 lbs	1 each
CENTER SUPT 8	Center Support for 8" wide tray.	2 lbs	1 each
CENTER SUPT 12	Center Support for 12" wide tray.	2.7 lbs	1 each
CENTER SUPT 16	Center Support for 16" wide tray.	3.3 lbs	1 each
CENTER SUPT 18	Center Support for 18" wide tray.	3.4 lbs	1 each
CENTER SUPT 20	Center Support for 20" wide tray.	3.8 lbs	1 each
CENTER SUPT 24	Center Support for 24" wide tray.	4.4 lbs	1 each

STANDARD FINISH: ZINC PLATED | AVAILABLE IN FINISHES: **BL**, **WH**, **PW**, **CUSTOM**, **SS**
 *ACCEPTS UP TO 1/2" THREADED ROD & SMALLER.

CEILING SUPPORTS



PART NUMBER	DESCRIPTION	WT. per pc.	QUANTITY per box
CEILING SUPT 12	Profile style support for 12" wide tray & smaller.	1.1 lbs	1 each
CEILING SUPT 16	Profile style support for 16" wide tray.	1.5 lbs	1 each
CEILING SUPT 18	Profile style support for 18" wide tray.	1.6 lbs	1 each
CEILING SUPT 20	Profile style support for 20" wide tray.	1.9 lbs	1 each
CEILING SUPT 24	Profile style support for 24" wide tray.	1.9 lbs	1 each

STANDARD FINISH: | AVAILABLE IN FINISHES: **BL**, **WH**, **PW**, **CUSTOM**, **SS**
 *HOLD DOWN METHOD (GROUND SPLICE) **NOT** INCLUDED.

RADIUS EXIT

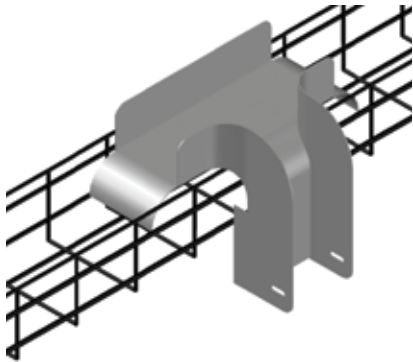

PART NUMBER	DESCRIPTION	WT. per pc.	QUANTITY per box
RADIUS EXIT	Radius Exit allows cables to exit over the side of 4/6" deep tray.	3.5 lbs	1 each

STANDARD FINISH: **BL** AVAILABLE FINISHES: **WH, PW, CUSTOM**
 *INSTALLATION HARDWARE INCLUDED.

RADIUS DOWN

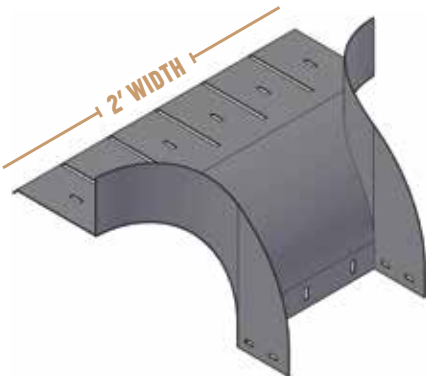

PART NUMBER	DESCRIPTION	WT. per pc.	QUANTITY per box
RADIUS DOWN 4	Radius Down with side panels for increased cable protection. Vertical funnel is 4" width. Allows connection between both trays.	2.5 lbs	1 each
RADIUS DOWN 6	Radius Down with side panels for increased cable protection. Vertical funnel is 6" width. Allows connection between both trays.	3.75 lbs	1 each
RADIUS DOWN 12	Radius Down with side panels for increased cable protection. Vertical funnel is 12" width. Allows connection between both trays.	7.5 lbs	1 each

STANDARD FINISH: **BL**
 AVAILABLE FINISHES: **WH, PW, CUSTOM**
 *WASHER SUPT PLUS SOLD SEPARATELY.

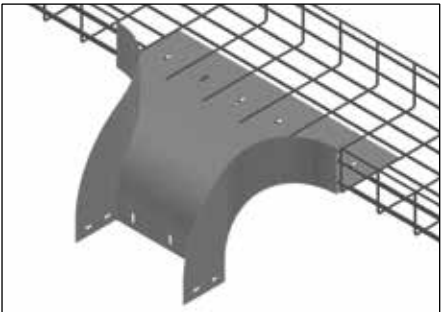

VERTICAL DOWN

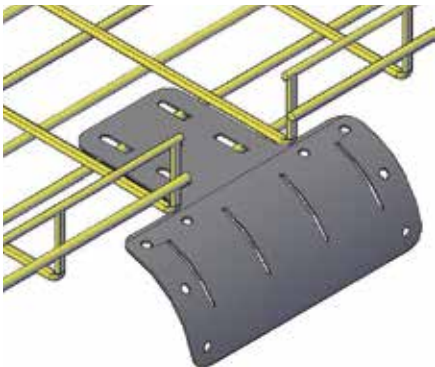

PART NUMBER	DESCRIPTION	WT. per pc.	QUANTITY per box
VERTICAL DOWN	Use the vertical down when dropping cables from the end or the side of tray. Dropout width is 8".	.6 lbs	1 each

STANDARD FINISH: ZINC PLATED
 AVAILABLE FINISHES: **BL, WH, PW, CUSTOM, SS**

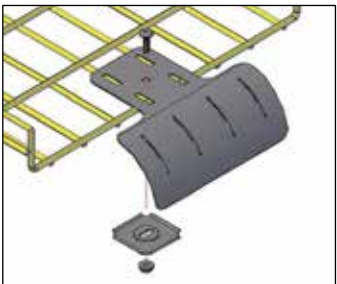

RACK SUPPORT

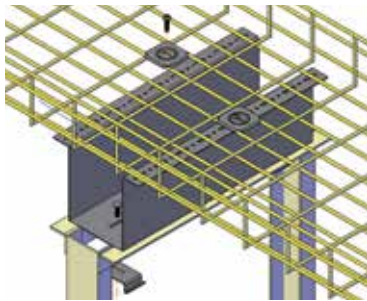

PART NUMBER	DESCRIPTION	WT. per pc.	QUANTITY per box
RACK SUPPORT	Elevates tray off a rack or cabinet.	7 lbs	1 kit

STANDARD FINISH: ZINC PLATED | AVAILABLE FINISH: **BL**, **WH**, **PW**, **CUSTOM**

RACK ATTACHMENT



PART NUMBER	DESCRIPTION	WT. per pc.	QUANTITY per box
RACK ATTACHMENT	Attaches tray directly to the top of a standard rack.	1 lb	1 kit

STANDARD FINISH: ZINC PLATED | AVAILABLE FINISH: **BL**, **WH**, **PW**, **CUSTOM**, **SS**

CABLE DROPOUT

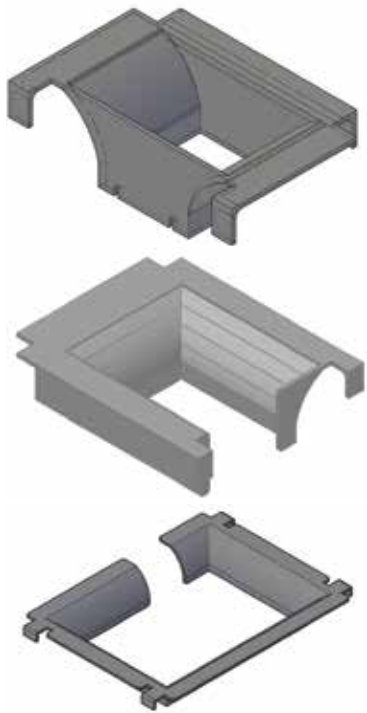

PART NUMBER	DESCRIPTION	WT. per pc.	QUANTITY per box
CABLE DROPOUT	Cable Dropout within the tray to protect bend radius. Can be stacked for multiple dropouts.	.03 lbs	1 each
CABLE DROPOUT 4X4	4" x 4" cable dropout within the tray to protect bend radius. Can be stacked for multiple dropouts.	.03 lbs	1 each
CABLE DROPOUT 6X8	6" x 8" cable dropout within the tray to protect bend radius. Can be stacked for multiple dropouts.	.03 lbs	1 each

STANDARD FINISH: **BL**

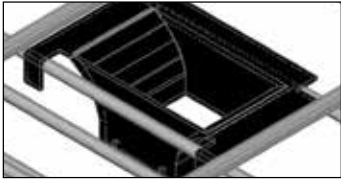
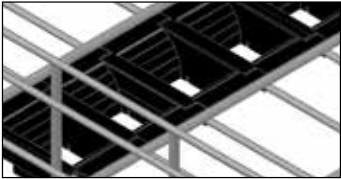

CABINET SUPPORT



PART NUMBER	DESCRIPTION	WT. per pc.	QUANTITY per box
WBTUS4	Independent cabinet support 4" H x 22" W.	1.9 lbs	1 each
WBTUS6	Independent cabinet support 6" H x 22" W.	2.1 lbs	1 each
WBTUS8	Independent cabinet support 8" H x 22" W.	2.4 lbs	1 each

STANDARD FINISH: | AVAILABLE IN FINISHES: **BL**, **WH**, **PW**, **CUSTOM**, **SS**

*HARDWARE PROVIDED WITH SUPPORT.

FLOOR SUPPORT

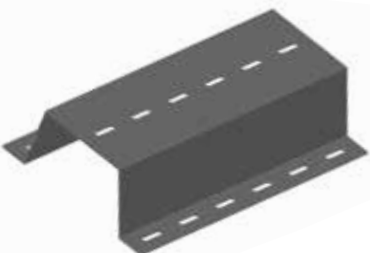

PART NUMBER	DESCRIPTION	WT. per pc.	QUANTITY per box
FLOOR SUPT _X_	Cabinet/Underfloor support for tray.	1-3 lb	1 each

STANDARD FINISH: | AVAILABLE IN FINISHES: **BL**, **WH**, **PW**, **CUSTOM**, **SS**

*ADDITIONAL HARDWARE SOLD SEPARATELY.

Z BRACKET



PART NUMBER	DESCRIPTION	WT. per pc.	QUANTITY per box
Z BRACKET _	Support for wall, underfloor or cabinet installation.	1-3 lb	1 each

STANDARD FINISH: | AVAILABLE IN FINISHES: **BL**, **WH**, **PW**, **CUSTOM**, **SS**

*ADDITIONAL HARDWARE SOLD SEPARATELY.

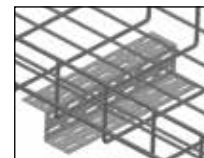

KEY: Z BRACKET width finish
(example: **Z BRACKET 12 WH** = 12" wide, white powder coat)

WIDTH	FINISH
4"-24"	PW/BL/WH for Standard Powder CPC for Custom Powder

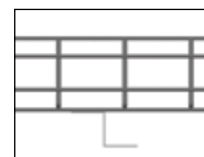

WALL MOUNT SUPPORT



PART NUMBER	DESCRIPTION	WT. per pc.	QUANTITY per box
WALL SUPT	Wall support for mounting 4" wide tray.	5 oz	1 each

STANDARD FINISH: | AVAILABLE IN FINISHES: **BL**, **WH**, **CUSTOM**, **SS**

=PRE-GALVANIZED FINISH

TERMINATION SUPPORT



PART NUMBER	DESCRIPTION	WT. per pc.	QUANTITY per box
TERM SUPPORT 6	Wall termination for 6" wide tray.	0.75 lb	1 each
TERM SUPPORT 8	Wall termination for 8" wide tray.	1 lb	1 each
TERM SUPPORT 12	Wall termination for 12" wide tray.	1.2 lbs	1 each
TERM SUPPORT 16	Wall termination for 16" wide tray.	1.4 lbs	1 each
TERM SUPPORT 18	Wall termination for 18" wide tray.	1.6 lbs	1 each
TERM SUPPORT 20	Wall termination for 20" wide tray.	1.75 lbs	1 each
TERM SUPPORT 24	Wall termination for 24" wide tray.	2 lbs	1 each

STANDARD FINISH: 

AVAILABLE IN FINISHES: **BL**, **WH**, **PW**, **CUSTOM**, **SS**
Custom widths available.
**ADDITIONAL HARDWARE SOLD SEPARATELY.*

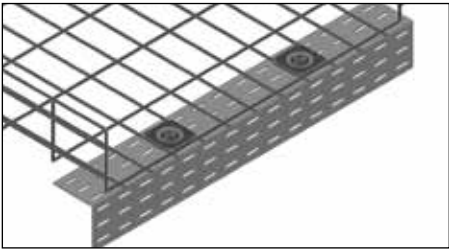

BLIND END

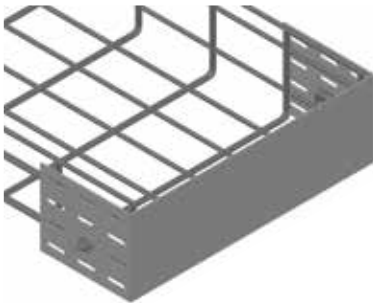

PART NUMBER	DESCRIPTION	WT. per pc.	QUANTITY per box
BLIND END__X__	A solid barrier at tray section end.	1-3 lbs	1 each

STANDARD FINISH:  | AVAILABLE IN FINISHES: **BL**, **WH**, **PW**, **CUSTOM**, **SS**

**ADDITIONAL HARDWARE SOLD SEPARATELY.*

CONDUIT ATTACHMENT



PART NUMBER	DESCRIPTION	WT. per pc.	QUANTITY per box
CONDUIT ATTACHMENT 3	Conduit to tray attachment. Available versions punched in 3/4", 1" and 1 1/2", or all punched same size.	1.5 lbs	1 each

STANDARD FINISH: 

AVAILABLE IN FINISHES: **BL**, **WH**, **PW**, **CUSTOM**, **SS**

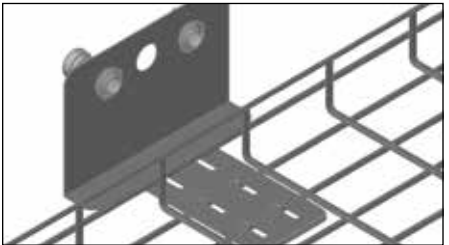

 = PRE-GALVANIZED FINISH

ELECTRICAL BOX

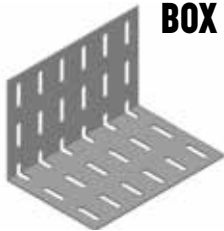

PART NUMBER	DESCRIPTION	WT. per pc.	QUANTITY per box
WBTELECTRICALBOX	Box to tray attachment.	0.75 lb	1 each

STANDARD FINISH:  | AVAILABLE IN FINISHES: **BL**, **WH**, **PW**, **CUSTOM**, **SS**

*ADDITIONAL HARDWARE SOLD SEPARATELY.

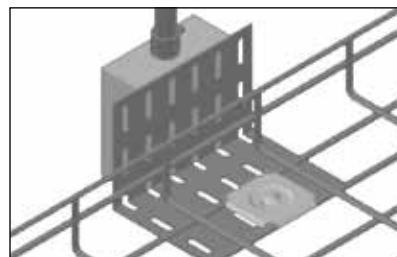

GROUND BOLT



PART NUMBER	DESCRIPTION	WT. per pc.	QUANTITY per box
GROUND BOLT	Ground bolt/lug to secure ground wire to tray sections.	0.5 lb	1 each

Conductive copper for ground/bond

LABEL CLIP



PART NUMBER	DESCRIPTION	WT. per pc.	QUANTITY per box
LABEL CLIP	Label Clip attachment for all sizes of tray.	0.1 lb	2 each

Polymer construction

CUTTING TOOL



PART NUMBER	DESCRIPTION	WT. per pc.	QUANTITY per box
CUTTING TOOL	Manual offset angled cutting tool with a 24" leveraged handle.	6 lbs	1 each

 =PRE-GALVANIZED FINISH

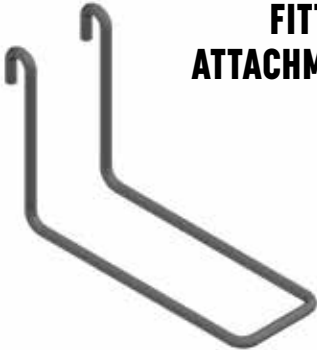

FITTING ATTACHMENT

PART NUMBER	DESCRIPTION	WT. per pc.	QUANTITY per box
FITTING ATTACHMENT 2	Use the fitting attachment 2 to fill the gap in 2" tray when creating fittings.	1 lb	1 each
FITTING ATTACHMENT 4/6	Use the fitting attachment 4/6 to fill the gap in 4" or 6" tray when creating fittings.	1 lb	1 each

STANDARD FINISH:

AVAILABLE IN FINISHES: **BL**, **WH**, **PW**, **CUSTOM**, **SS**



SIDECAR

PART NUMBER	DESCRIPTION	WT. per pc.	QUANTITY per box
SIDE CAR 2	Additional cable support 2" deep.	0.5 lb	1 each
SIDE CAR 4	Additional cable support 4" deep.	0.5 lb	1 each

STANDARD FINISH:

AVAILABLE IN FINISHES: **BL**, **WH**, **PW**, **CUSTOM**, **SS**

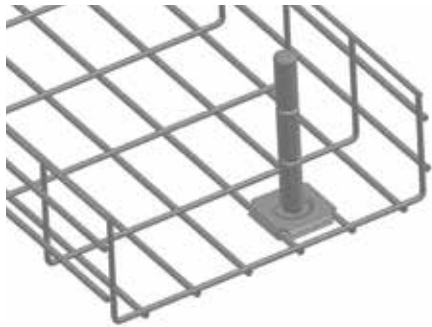
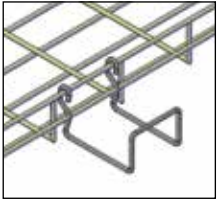

CABLE GUIDE

PART NUMBER	DESCRIPTION	WT. per pc.	QUANTITY per box
CABLE GUIDE	The cable guide is used to maintain cable bend radius when routing or pulling cables through fittings. It can also be used as a divider for straight sections as well as fittings.	1 lb	1 each

Polymer construction

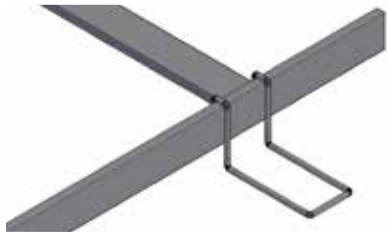
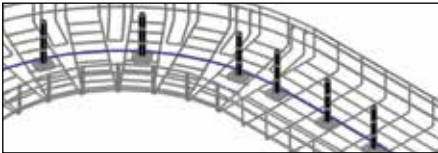

LADDER RACK CLIP

PART NUMBER	DESCRIPTION	WT. per pc.	QUANTITY per box
LADDER RACK CLIP	Pressure mounted bracket to install 4" width tray to existing ladder rack.	1 lb	1 each

STANDARD FINISH:

AVAILABLE IN FINISHES: **BL**, **WH**, **PW**, **CUSTOM**

*INSTALLATION HARDWARE INCLUDED.

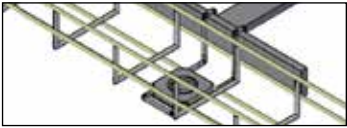

WBTFORM Non metallic solutions

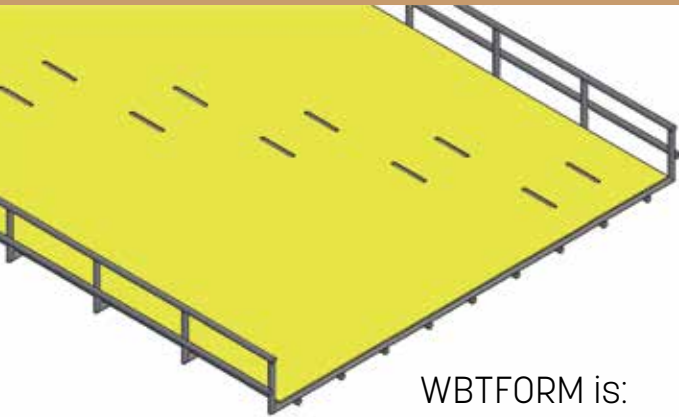

WBT is proud to introduce WBTFORM, a new system for utilizing flame retardant polymer for use in creating tray inserts and covers. WBTFORM allows you to configure the material as a tray liner or insert, with the option of a flat bottom, or prescored to the tray depth for coverage of the bottom and sides.

WBTFORM can even be utilized to envelop the entire tray, providing bottom, side and cover protection. WBTFORM is easily configurable into a variety of solutions from the simple to creative.

WBTFORM is:

- **UL 94V-0 Flame Class Rating.**
- **RoHS compliant.**
- **Non-hydroscopic (moisture absorption <0.1%).**
- **Temperature range to 115°C/239°F.**
- **Easily field configurable.**
- **Can be prescored at the factory for specific applications.**
- **Available in black, white, red, blue, yellow, green or any custom color*.**

WBTFORM



PART NUMBER	DESCRIPTION	WT. per pc.	QUANTITY per box
WBTFORM04	Polymer bottom insert for 4" wide tray 10' long.	0.5 lb	1 each
WBTFORM06	Polymer bottom insert for 6" wide tray 10' long.	0.65 lb	1 each
WBTFORM08	Polymer bottom insert for 8" wide tray 10' long.	0.75 lb	1 each
WBTFORM12	Polymer bottom insert for 12" wide tray 10' long.	1 lb	1 each
WBTFORM16	Polymer bottom insert for 16" wide tray 10' long.	1.25 lbs	1 each
WBTFORM18	Polymer bottom insert for 18" wide tray 10' long.	1.5 lbs	1 each
WBTFORM20	Polymer bottom insert for 20" wide tray 10' long.	1.75 lbs	1 each
WBTFORM24	Polymer bottom insert for 24" wide tray 10' long.	2.25 lbs	1 each

***WBTFORM parts are supplied as one continuous roll, up to 250'.**

STANDARD FINISH: **BL** AVAILABLE IN FINISHES: **WH, CUSTOM***

KEY: WBTFORM depth X width (example: **WBTFORM2X12** = 2" deep X 12" wide tray)

WBTFORM W/SIDES



PART NUMBER	DESCRIPTION	WT. per pc.	QUANTITY per box
WBTFORM__X__	Polymer bottom insert with sides for specific tray depth and width 10' long.	varies	1 each

***WBTFORM parts are supplied as one continuous roll, up to 250'.**

STANDARD FINISH: **BL** AVAILABLE IN FINISHES: **WH, CUSTOM***



NOTE: Always check with local building/codes enforcement to insure WBTFORM is allowed and approved for installation environment

*Subject to minimum order

WBT-3

INTRODUCING WBT-3: A SECURE, THREE SIDED COVERING FOR CABLETRAY.

Another innovative approach, WBT has engineered a secure covering to completely hide and protect your cabling. With technology continuing to advance, security of information being shared is at a larger risk than it ever has been. WBT-3 provides needed protection, by hiding the tray and cabling in plain sight. With our integrated fastening system for WBT-3, cabling media is out of sight, while still allowing easy access to the pathway. Simply hook one side of WBT-3 onto the top side of the cable tray, feed it to hug the underside of the tray, and hook the other side on the opposite side of the cabletray. Finishes are available to match the aesthetic of the workspace- the options are infinite.

- **Cost-effective alternative solution to solid trough style tray. Saves on material and labor.**
- **Available in an unlimited variety of colors**
- **Easily secures and hides cabletray in plain sight.**
- **Quick installation with our integrated attachment system.**
- **WBT-3 is an innovative, protective covering ONLY WBT can offer.**

WBT-3

KEY: WBT3^{depth}X^{width} (example: **WBT3-4X12** = 4" deep X 12" wide)



PART NUMBER	DESCRIPTION	WT. per pc.	QUANTITY per box
WBT3-__X__	wide outer sleeve for tray pre-galvanized steel	1 lb	1 each

STANDARD FINISH: AVAILABLE IN FINISHES: **BL**, **WH**, **PW**, **CUSTOM**

COVERS

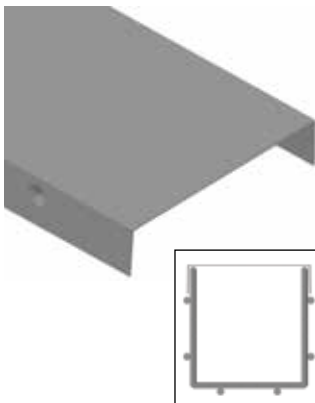

PART NUMBER	DESCRIPTION	WT. per pc.	LENGTH
COVER4	Metal cover for 4" wide tray galvanized.	3 lbs	5'
COVER6	Metal cover for 6" wide tray galvanized.	3.5 lbs	5'
COVER8	Metal cover for 8" wide tray galvanized.	4.5 lbs	5'
COVER12	Metal cover for 12" wide tray galvanized.	6 lbs	5'
COVER16	Metal cover for 16" wide tray galvanized.	8 lbs	5'
COVER18	Metal cover for 18" wide tray galvanized.	8.5 lbs	5'
COVER20	Metal cover for 20" wide tray galvanized.	9.5 lbs	5'
COVER24	Metal cover for 24" wide tray galvanized.	11 lbs	5'

STANDARD FINISH: AVAILABLE IN FINISHES: **BL**, **WH**, **PW**, **CUSTOM**

STEEL INSERTS



PART NUMBER	DESCRIPTION	WT. per pc.	LENGTH
INSERT__X__	Solid insert with sides used with corresponding tray, galvanized.	varies	5'

STANDARD FINISH: AVAILABLE IN FINISHES: **BL**, **WH**, **PW**, **CUSTOM**

*WASHER SUPT PLUS SOLD SEPARATELY.

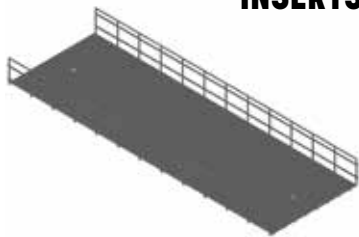

INSERTS

PART NUMBER	DESCRIPTION	WT. per pc.	LENGTH
INSERT4	Solid insert used with 4" wide tray galvanized.	3.5 lbs	5'
INSERT6	Solid insert used with 6" wide tray galvanized.	5 lbs	5'
INSERT8	Solid insert used with 8" wide tray galvanized.	7 lbs	5'
INSERT12	Solid insert used with 12" wide tray galvanized.	11 lbs	5'
INSERT16	Solid insert used with 16" wide tray galvanized.	13.5 lbs	5'
INSERT18	Solid insert used with 18" wide tray galvanized.	16.5 lbs	5'
INSERT20	Solid insert used with 20" wide tray galvanized.	18 lbs	5'
INSERT24	Solid insert used with 24" wide tray galvanized.	20 lbs	5'

STANDARD FINISH:  AVAILABLE IN FINISHES: **BL**, **WH**, **PW**, **CUSTOM**

*WASHER SUPT PLUS SOLD SEPARATELY.

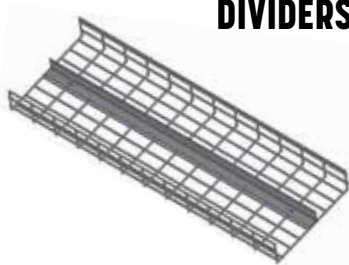

DIVIDERS

PART NUMBER	DESCRIPTION	WT. per pc.	LENGTH
DIVIDER2	Divider used with 2" deep tray galvanized.	2 lbs	5'
DIVIDER4	Divider used with 4" deep tray galvanized.	5 lbs	5'
DIVIDER6	Divider used with 6" deep tray galvanized.	7.5 lbs	5'
DIVIDER8	Divider used with 8" deep tray galvanized.	10 lbs	5'

STANDARD FINISH:  AVAILABLE IN FINISHES: **BL**, **WH**, **PW**, **CUSTOM**

*WASHER SUPT PLUS SOLD SEPARATELY.



FLEX DIVIDERS

PART NUMBER	DESCRIPTION	WT. per pc.	LENGTH
FLEX DIVIDER 2	4" perforated divider clip (2" to be removed by snapping off) along with 2" high x 10' long flexible polymer divider wall. Includes 4 divider posts.	1.5 lbs	10'
FLEX DIVIDER 4	4" perforated divider clip, along with 4" x 10' long flexible polymer divider wall. Includes 4 divider posts.	3 lbs	10'
FLEX DIVIDER 6	4" perforated divider clip, along with 6" x 10' long flexible polymer divider wall. Includes 4 divider posts.	4.5 lbs	10'

*Divider polymer parts are supplied as one continuous roll, up to 250'.

• Polymer Divider is UL 94V-0 Flame Class Rating.

STANDARD FINISH: **BL** AVAILABLE IN FINISHES: **WH**

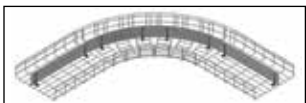

DIVIDER POST



PART NUMBER	DESCRIPTION	WT. per pc.	QUANTITY per box
DIVIDER POST	4" high polymer snap on divider post for 2", 4", or 6" divider. 2" may be snapped off for use with 2" tray.	.5 lbs	1 each

STANDARD FINISH: **BL** AVAILABLE IN FINISHES: **WH**

 = PRE-GALVANIZED FINISH

SUPPORT

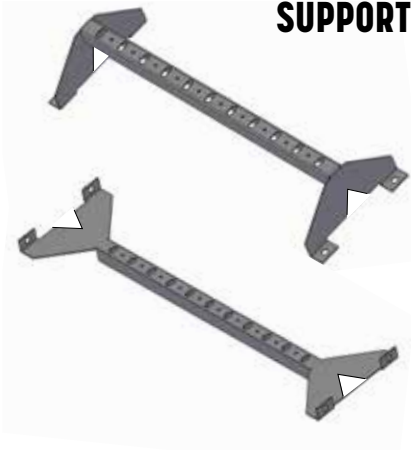

PART NUMBER	DESCRIPTION	WT. per pc.	QUANTITY per box
WBTUS4	Independent Underfloor support 4" H x 22" W	1.9 lbs	1 each
WBTUS6	Independent Underfloor support 6" H x 22" W	2.1 lbs	1 each
WBTUS8	Independent Underfloor support 8" H x 22" W	2.4 lbs	1 each
WBTUS10	Independent Underfloor support 10" H x 22" W	3.0 lbs	1 each
WBTUS12	Independent Underfloor support 12" H x 22" W	3.5 lbs	1 each
WBTUS14	Independent Underfloor support 14" H x 22" W	4.1 lbs	1 each
WBTUS16	Independent Underfloor support 16" H x 22" W	4.7 lbs	1 each
WBTUS18	Independent Underfloor support 18" H x 22" W	5.3 lbs	1 each

STANDARD FINISH: | AVAILABLE IN FINISHES: **BL**, **WH**, **PW**, **CUSTOM**

*HARDWARE PROVIDED WITH SUPPORT.

GROUND/HOLD DOWN

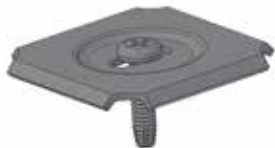

PART NUMBER	DESCRIPTION	WT. per box	QUANTITY per box
GROUND SPLICE	Ground/hold down method used with underfloor tray.	7 lbs	50 sets

STANDARD FINISH: | AVAILABLE IN FINISHES: **BL**

PEDESTAL CLAMP



PART NUMBER	DESCRIPTION	WT. per box	QUANTITY per box
PEDESTAL CLAMP	Underfloor support clamp.	0.5 lbs	1 each

STANDARD FINISH: 



PEDESTAL KIT



PART NUMBER	DESCRIPTION	WT. per box	QUANTITY per box
PEDESTAL KIT	Underfloor support kit. Includes 2 pedestal clamps, profile support and hardware.	3 lbs	1 each

STANDARD FINISH: 

FLOOR SUPPORT

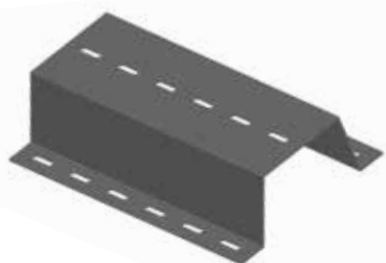

PART NUMBER	DESCRIPTION	WT. per pc.	QUANTITY per box
FLOOR SUPT _X_	Cabinet/Underfloor support for tray.	1-3 lb	1 each

STANDARD FINISH:  | AVAILABLE IN FINISHES: **BL**, **WH**, **PW**, **CUSTOM**

*WASHER SUPT PLUS SOLD SEPARATELY.

SEE PART NUMBER KEY ON PAGE 14

*STANDARD DEPTHS ARE 4" AND 6". OTHER CUSTOM DEPTHS ARE AVAILABLE.

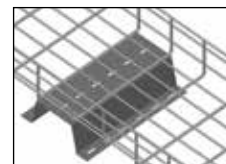

VERTICAL UP

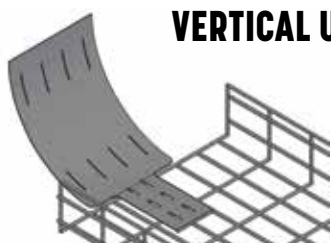

PART NUMBER	DESCRIPTION	WT. per box	QUANTITY per box
VERTICAL UP	The Vertical Up is used when transitioning cabling up from a raised computer floor.	1.75 lbs	1 each

STANDARD FINISH:  | AVAILABLE IN FINISHES: **BL**, **WH**, **PW**, **CUSTOM**

STAINLESS STEEL

In addition to our standard galvanized, zinc plated, and powder coated tray, WBT also offers a Stainless Steel solution tray and supports for industrial applications such as solar projects, food processing plants, marine applications, and other locations that will be exposed to moisture and/or corrosive environments. WBT's Stainless Steel option is available on many of our products and holds a minimal lead time. Contact a WBT representative today to learn more!

STAINLESS STEEL IS AVAILABLE ON:

- **Tray**
- **Splice Kits**
- **Washer Supports**
- **Bar Splice**
- **Corner Splice**
- **Mounting Accessories**



APPLICATIONS FOR WBT

Whatever your project details, WBT has a solution (standard or custom) to meet your leadtimes and budgets, and to exceed your expectations.

WBT INDUSTRY FIRSTS

- WBT Shaped wire (patented) for increased support and minimized cable strain
- WBT PreForm saves installation time and labor, while providing a better engineered install
- WBT NoSplice eliminates the need for additional materials/labor. Splice and support in one step
- NEW WBT flex divider allows faster installs and the ability to navigate pathway turns
- NEW WBT Transition for vertical elevation changes without the need to cut and configure
- WBTForm provides a solid flame-rated polymer insert for bottom and sides
- NEW WBTForm colors allow tray and form to match an unlimited combination of environments
- UL Classified painted tray means no need to remove paint at splice points to ground/bond
- UL Classified 2x4S tray is the only industry UL Classified 2x4 tray. No additional grounding
- Green PreGalv finish
- Cable Dropout for pathway bottom cable exits, available in 2x4, 4x4 and 6x8
- Sidecar allows for secondary pathway outside of main tray

COMMUNICATIONS/DATACOM



- Largest number/variety of trays and UL certified solutions
- Shaped tray for increased cabling support
- Industry best leadtimes on shipments and specials
- UL Classified on all painted tray colors

INDUSTRIAL/ELECTRICAL



- Full offering of solutions to install tray in any industrial environment
- Higher loading capabilities allow for higher quantities and heavier cables
- Stainless steel tray, mounting accessories and splicing hardware for outdoor, caustic environments, food preparation and marine/offshore
- Custom tray configurations and solutions for unique environments
- Full inventory of trays and support products for quick ship capabilities

MARINE/OFFSHORE



- WBT offers Stainless Steel tray, mounting accessories and splicing hardware for marine/offshore
- Hot Dipped tray sections for severe/outdoor installation environments
- Shaped tray offers higher load capabilities than competitive round/round constructions

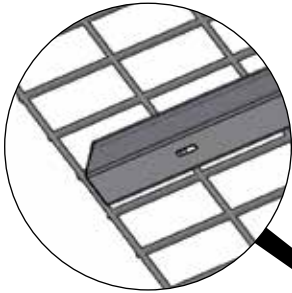

DIVIDER
PAGE 27



RADIUS DOWN
PAGE 19

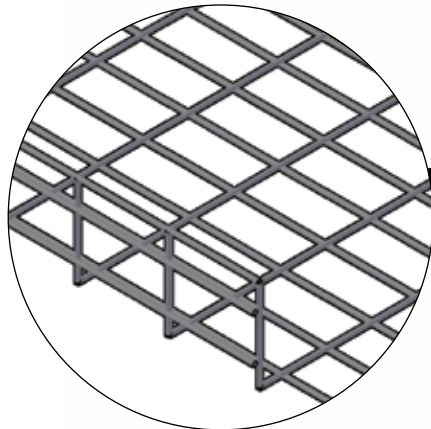

WBT TRAY
PAGE 6

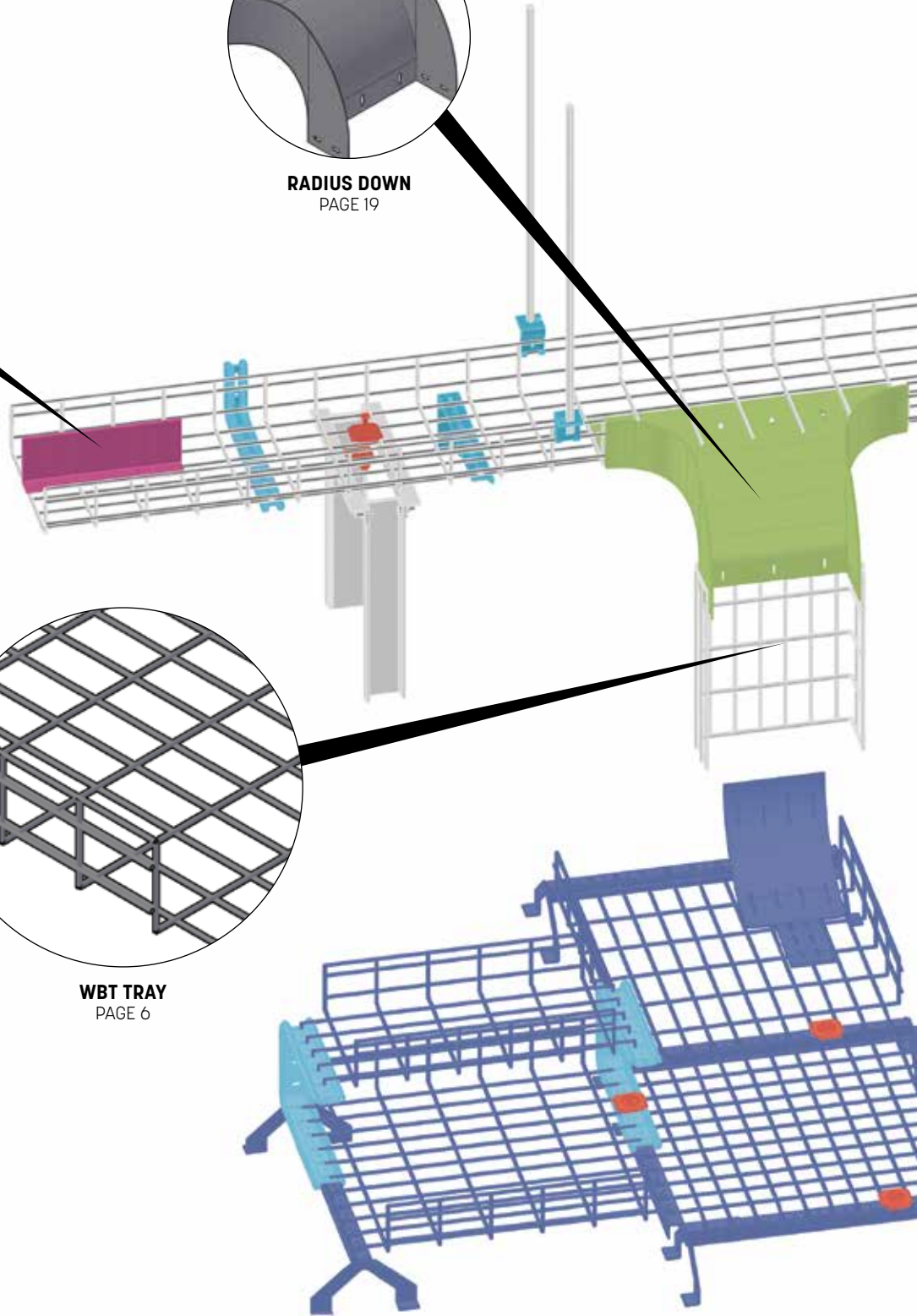

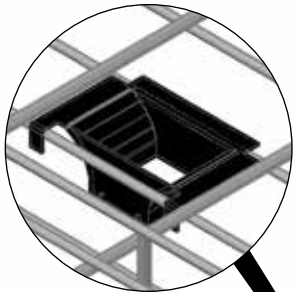

CABLE DROPOUT
PAGE 20

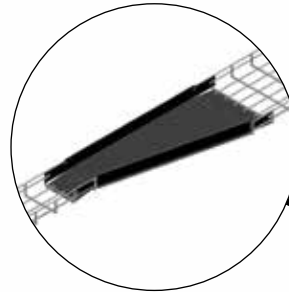

PreForm TRAY REDUCE & COVER
PAGE 8

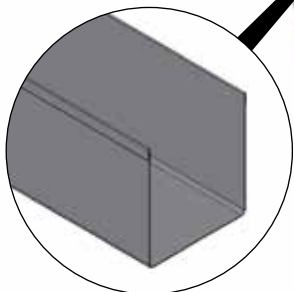

STEEL INSERT
PAGE 26

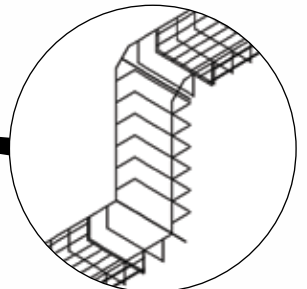

PreForm TRANSITION
PAGE 9

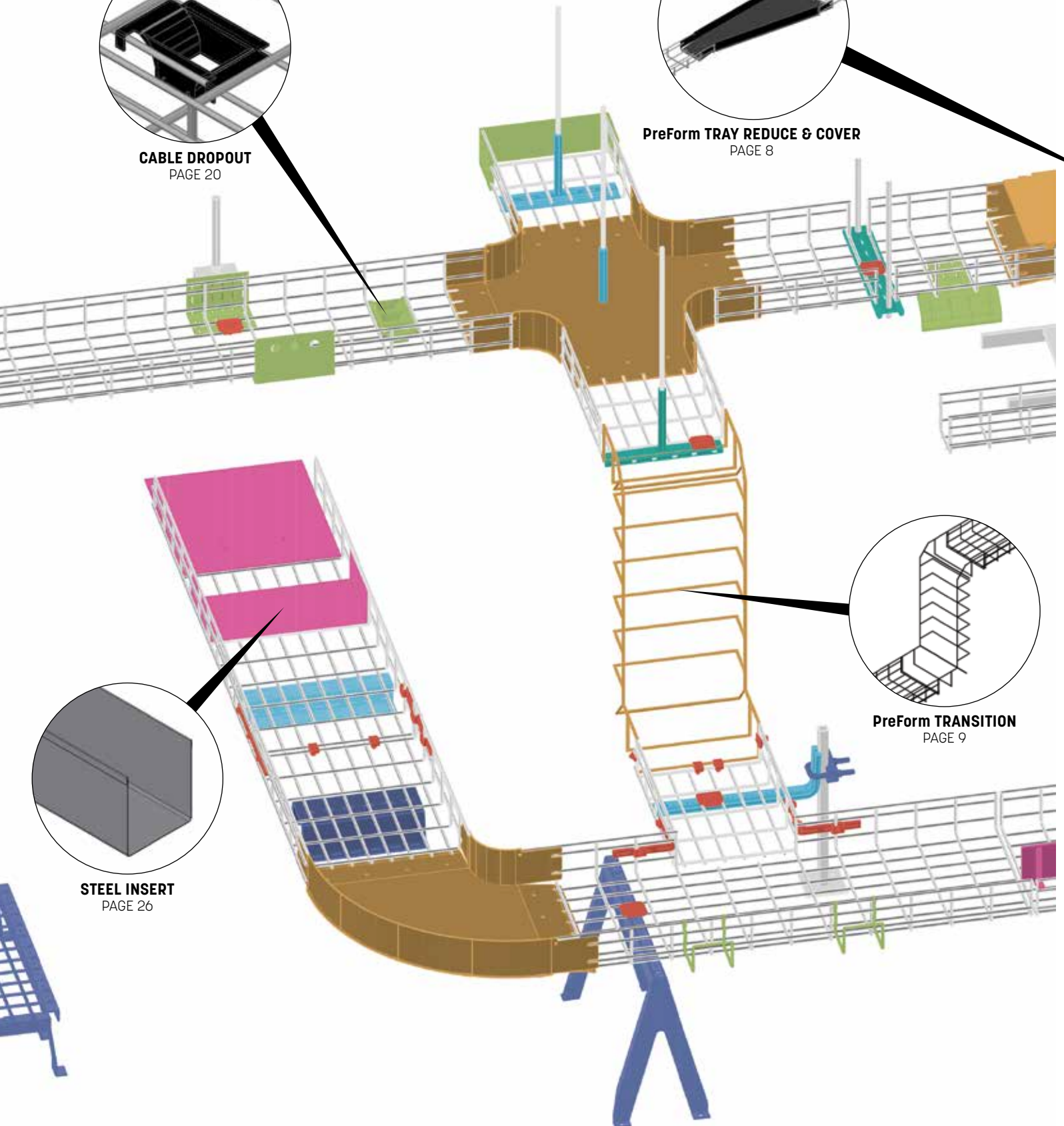

PARTS CATEGORY KEY

WBT PreForm

PAGE 8

WBT PowerShear

PAGE 11

SPLICING

PAGE 12

SUPPORTS

PAGE 16

ACCESSORIES

PAGE 19

WBT-3

PAGE 26

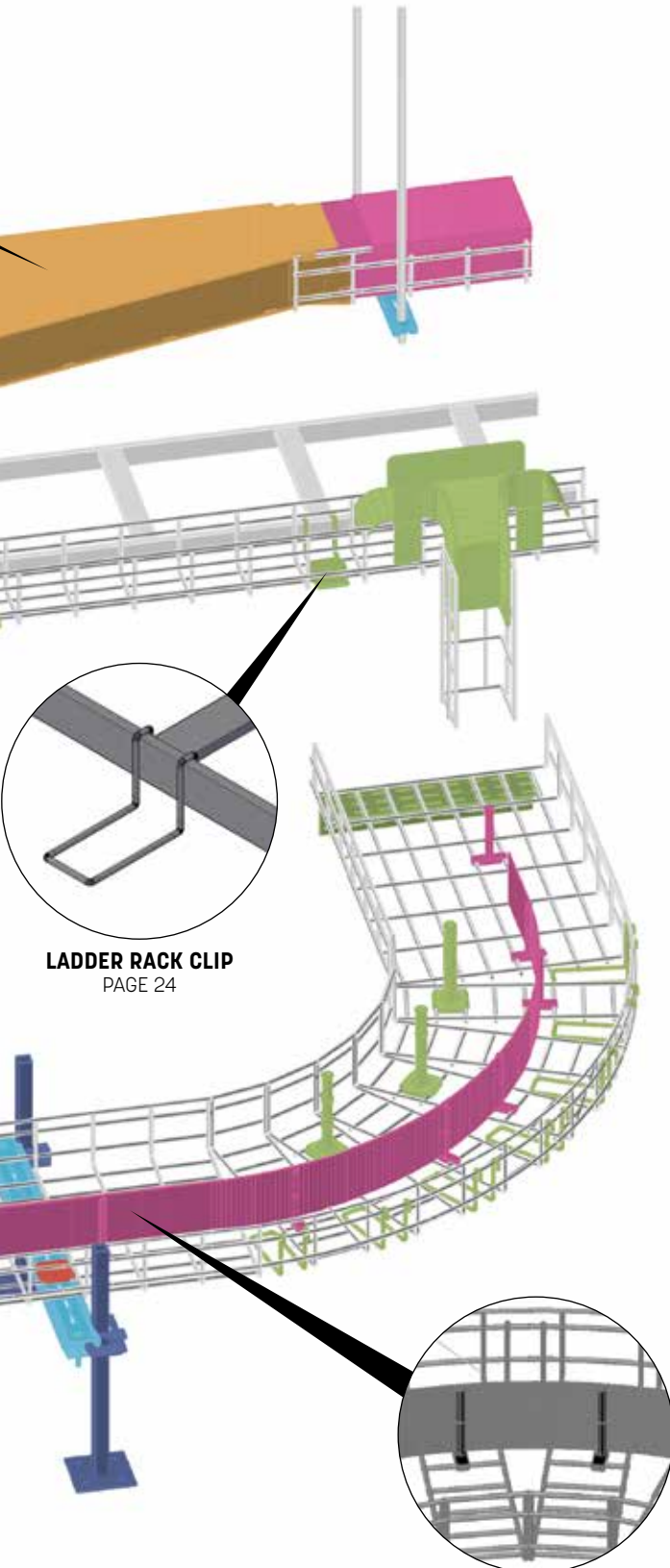

LADDER RACK CLIP
PAGE 24

FLEX DIVIDERS
PAGE 27

VISIT US ONLINE: **WWW.WBTRAY.COM**

CALL US TOLL FREE: **888.4WB.TRAY**

(888.492.8729)

WBT offers unrivaled Customer Support.

- Installation assistance
- Free BOM from your drawings or blueprints
- Bid Specification Documents
- Engineering Drawings
- Design Assistance
- Custom Fabricated parts for your specific installation needs

CONTACT US

Email us: sales@WBTray.com

Call us toll free: **888.4WB.TRAY** (888.492.8729)

Call us locally: **618.918.3821**

VISIT US ONLINE: **WWW.WBTRAY.COM**

WBT gives you access to a bevy of valuable online tools and forms such as cut sheets, CSI specs, technical specs, certified test reports & more.

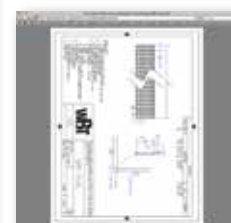
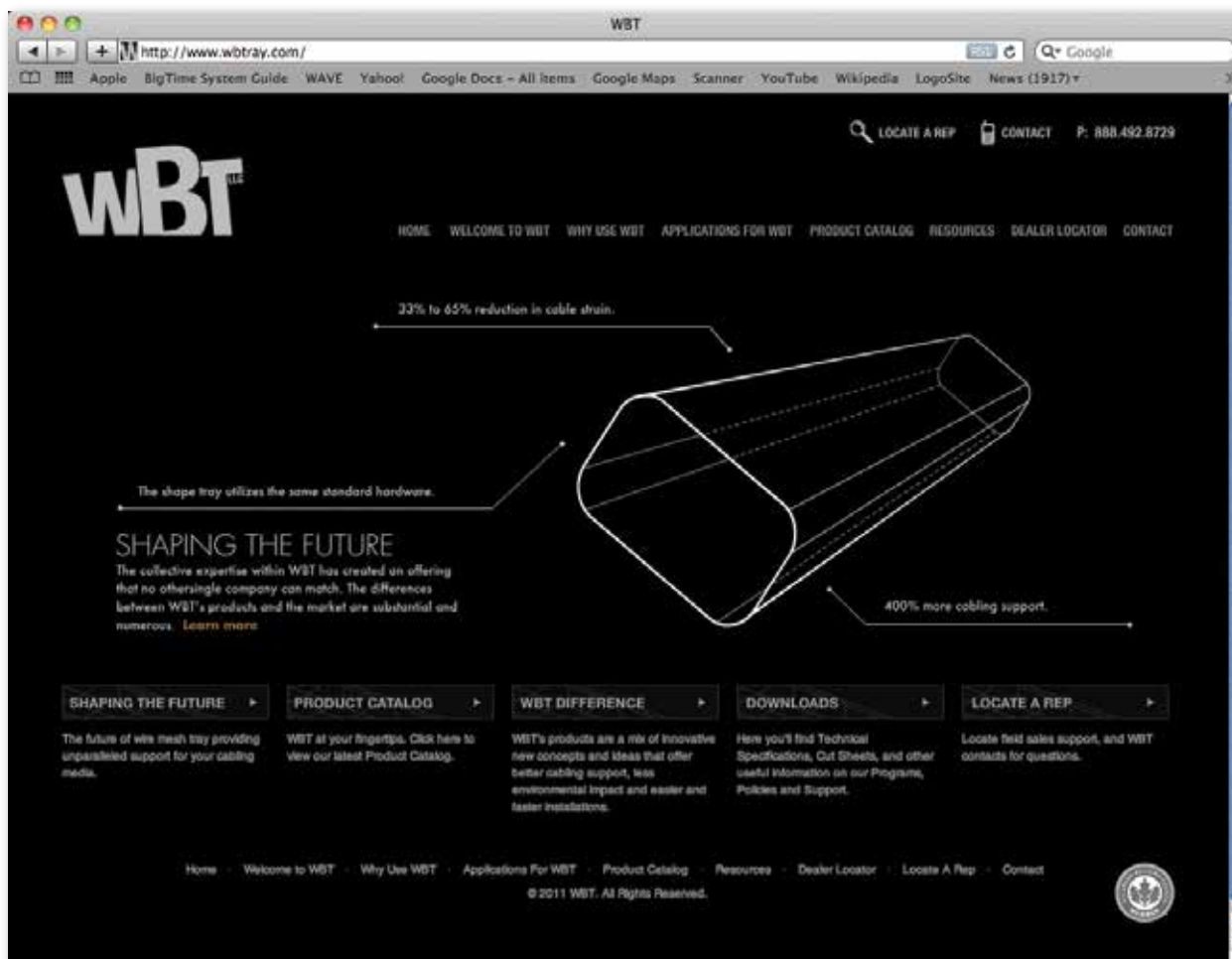

As part of a process of ongoing innovation, WBT reserves the right to change specifications without prior notice. This includes changes in product dimensions, materials and finish material/processes and product availability. Please consult WBT for any questions.

It is acknowledged that all Trade Marks, Product Data, Logos, etc. used within this catalog are the sole and exclusive property of WBT LLC.

WBT^{LLC}

WBT^{LLC}
PERFORMANCE CABLETRAY™

115 Harting Drive | Centralia, IL 62801

2140 South Douglas Drive | Chandler, AZ 85286

888.4WB.TRAY | WBTRAY.COM

